

TP326

Project

Eagle House
Wimbledon
London



thermotec



Contractors / Partners



TP326

Project

Eagle House
Wimbledon
London



Project Brief

In consultation with Octagon, Thermotec were asked to provide a complete design and installation scheme, in compliance with the latest environmental and technological heating systems.

Scope of Works

Thermotec delivered a fully integrated floor build up system from the sub-floor base to the final floor screed using our TPA11 Aquafloor Cliprail underfloor heating system and insulation using standard thermostats. The project was managed, installed and supervised by Thermotec, and was delivered on time and within budget.

Project Value: £5M

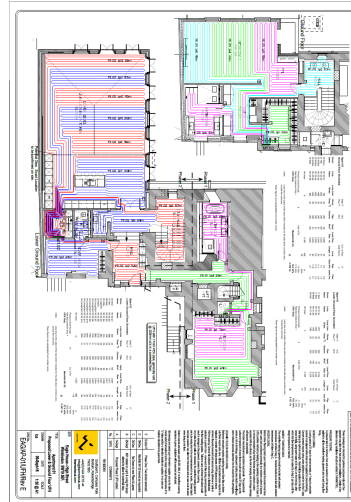

Project Details

Eagle house has recently been extensively refurbished converting the iconic grade 11 listed jacobean building into 8 luxury apartments, resulting in a truly exquisite and unique landmark building. This prestigious building is located in a prime location in Wimbledon Village, ideally placed for Wimbledon Common, Richmond Park, Wimbledon All England Lawn Tennis Club, golf clubs including the Royal Wimbledon Golf Club, riding stables – and the chic boutiques, popular restaurants and bars of The Village High Street.



thermotec

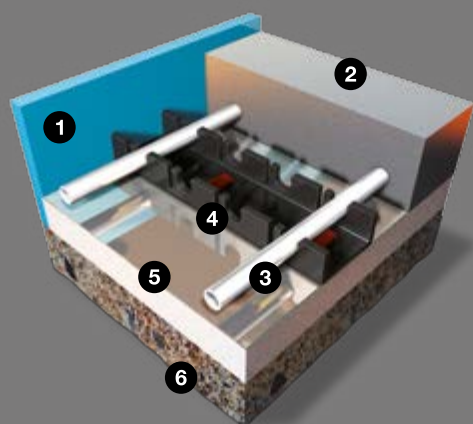

Aquafloor Installation

- 1 Expansion edging strip
- 2 Screed minimum 65mm
- 3 Aquafloor heating pipe
- 4 Heating pipe rail
- 5 Foil faced insulation min 25mm
- 6 Solid sub-floor



Unsurpassed in logistics
and project planning.
Assured quality installations
for the mechanical and
electric sector.

thermotecuk.com